



St Helena

Welcome



[Watch Video](#)

http://youtube.com/watch?v=AVASERi_t_4



Discover where your family story really begins at St Helenas Village in Lochinvar. Settle here and enjoy the idyllic life balance - where less maintenance, means more lifestyle.

Situated on the western fringe of Lochinvar the estate offers near-level allotments perfect for building your dream home, with minimal site costs. These generous-sized sites are ideal for those wanting to potter in the yard, but not have the chore of up keeping their land.

It's an estate where children have room to move and sheds can be filled with recreational toys. But, most importantly, it's a place where families have time and space to connect in the comfort of their own homes.

Upon entering the suburb you'll know you are located well. Established schools, community services, historic churches and essential shops line the main street. For those with additional needs, rest assured, major hospitals, Maitland's shopping precincts and community services are only 13km away.

Education in the town is vast with Lochinvar Primary School, St Nicholas Early Education, St Patrick's Primary School and St. Joseph's of Lochinvar, which now offer years 11 and 12, all within approximately 2km of the estate. Hunter Valley Grammar School is also only a 20 minute drive away.

For the more cultural at heart the Hunter Valley's finest wine growing area is at your doorstep and with more cellar doors than any other wine region in Australia, you'll be spoilt for choice.

Anyone commuting to work can relax with the knowledge that the Hunter Expressway, only a short 3 minute drive away, helps cut travel times to the Hunter Valley employment opportunity area and Newcastle CBD by up to 30 minutes.

Build your new home here and you'll be situated among other quality sites with the benefits of semi-rural living and the convenience of modern trends at your fingertips





Price List

LOT	SIZE (SQM)	PRICE
265	900	\$525,000
220	1456	UNDER CONTRACT
546	3293	UNDER CONTRACT

Individual Lot Plans

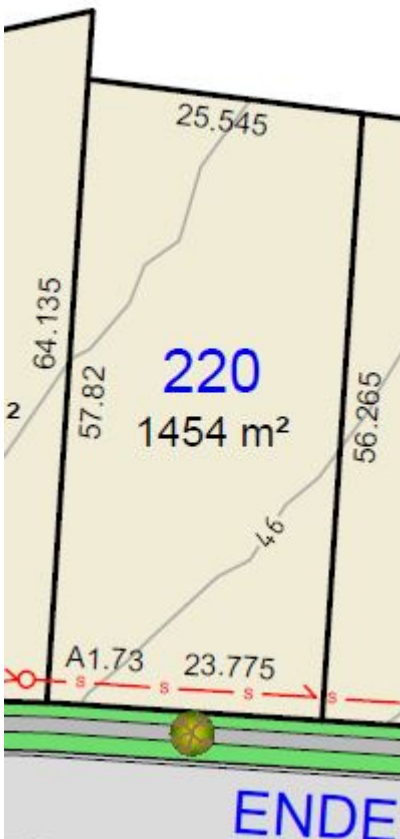
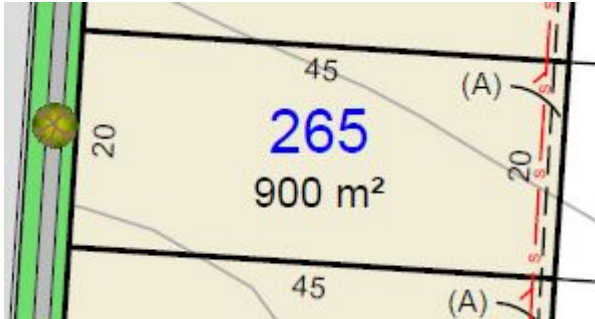

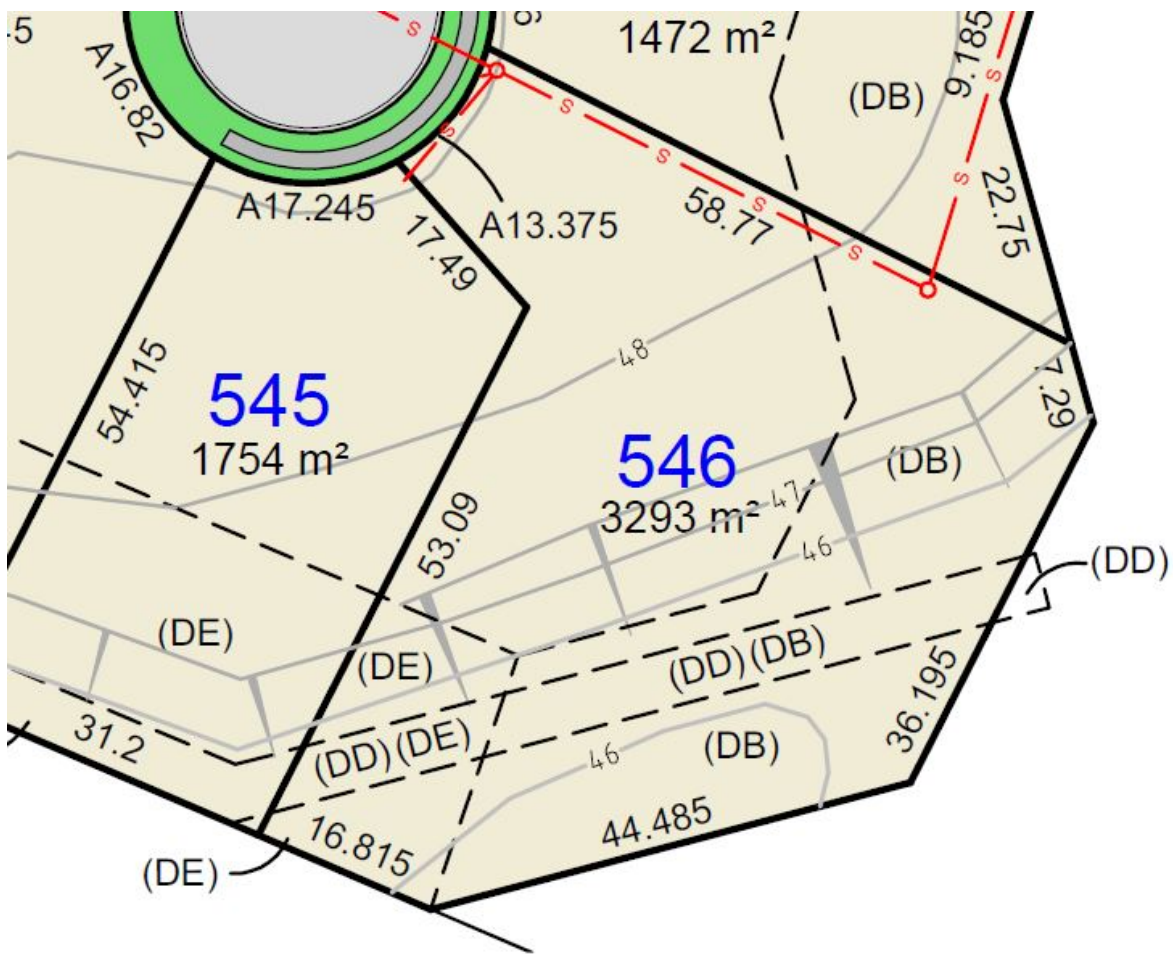

Sales Plans

Sales Plan Stage 2



Sales Plan Stage 2



Sales Plan Stage 5



Location Map

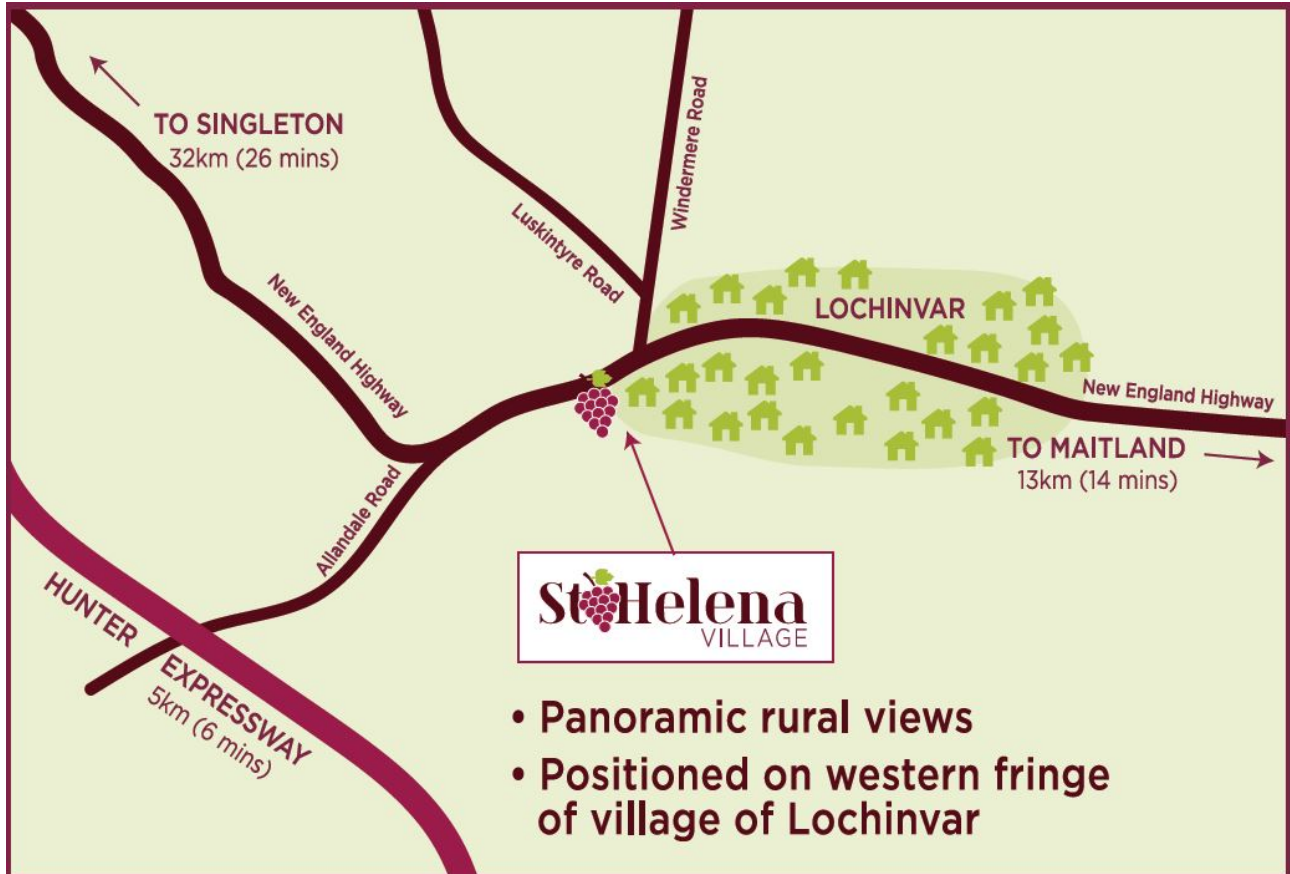

Around the Area

Living in St Helenas Village you will have access to all that Lochinvar has to offer and the vast benefits of the Hunter.

When living here you will become part of the overarching Maitland Local Government Area with the regional hubs of Rutherford, Maitland and East Maitland only a short distance away.

The closest, less than 8km away, is Rutherford. Here there is an industrial and retail complex as well as a shopping centre. Combined they are home to major retailers including Aldi, Officeworks, Woolworths, Spotlight, Harvey Norman, as well as, a variety of other stores.

Only 13km away is the Maitland CBD home to the area's major public hospital and retailers including K-Mart and Woolworths. Parks, shopping centres, niche markets and a variety of other essential services are also located here.

A little further down the road, approximately 16km away, is Stockland Green Hills Shopping Centre in East Maitland. Major retailers include David Jones, Woolworths, Coles, Big W, Dan Murphy's, Target, JB Hi Fi, speciality shops, theatres and restaurants.

Recreation sporting associations in the area include football, rugby league, health and fitness, netball, swimming, cricket, tennis and rugby union. Maitland Park and swimming pool are also only 13km away and with work on a new heated indoor swimming pool underway.

Outside of Lochinvar to the northwest there is a large equestrian development as well as a number of wineries and cellar doors. With more cellar doors than any other wine region in Australia, the Hunter Valley is perfect for wine tasting.

Living in St Helenas Village you will have access to all that Lochinvar has to offer and the vast benefits of the Hunter.

When living here you will become part of the overarching Maitland Local Government Area with the regional hubs of Rutherford, Maitland and East Maitland only a short distance away.

The closest, less than 8km away, is Rutherford. Here there is an industrial and retail complex as well as a shopping centre. Combined they are home to major retailers including Aldi, Officeworks, Woolworths, Spotlight, Harvey Norman, as well as, a variety of other stores.

Only 13km away is the Maitland CBD home to the area's major public hospital and retailers including K-Mart and Woolworths. Parks, shopping centres, niche markets and a variety of other essential services are also located here.

A little further down the road, approximately 16km away, is Stockland Green Hills Shopping Centre in East Maitland. Major retailers include David Jones, Woolworths, Coles, Big W, Dan Murphy's, Target, JB Hi Fi, speciality shops, theatres and restaurants.

Recreation sporting associations in the area include football, rugby league, health and fitness, netball, swimming, cricket, tennis and rugby union. Maitland Park and swimming pool are also only 13km away and with work on a new heated indoor swimming pool underway.

Outside of Lochinvar to the northwest there is a large equestrian development as well as a number of wineries and cellar doors. With more cellar doors than any other wine region in Australia, the Hunter Valley is perfect for wine tasting.

Our Details

With unique sweeping views and only a few minutes from all the conveniences of Maitland and the Hunter Valley these lots will not last long.

For more information on one of these prestigious spaces or to speak to one of our exclusive sales agents contact Peters Real Estate now.

Phone: 4933 7855

Email: customerservice@petersrealestate.com.au

Drop in: 475-477 High Street, Maitland

Facebook: www.facebook.com/petersrealestatemaitland/